

## Intake Valve - ATV, Hisun, 700cc - 20A2563 - PBC1459F1

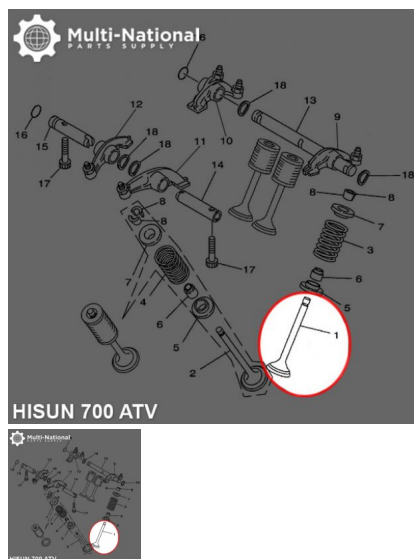

Rating: Not Rated Yet

**Price**

\$39.19

[Ask a question about this product](#)

### Description

30mm intake valve. Commonly used for (but not limited to) 700cc engines, such as the Hisun 700cc 4x4 ATVs, as well as many other clones, rebrands and similar displacement machines.

These machines are commonly manufactured by Chongqing Huansong Industries (Group) Co., Ltd. and distributed by a range of exporters, importers and distributors under such brands as: Hisun, Bennche, Coleman, Massimo, Qlink, Menards Yardsport, Big Muddy, Powermax, Nordik, TSC, Rural King, Cub Cadet, Excalibur, US Titan / Supermach, Precision, JMC and many others.

Common Hisun model names are primarily listed as variations of "Hisun 700cc ATV", "Hisun HS700ATV" and "HSUN HS700 E-mark EFI". Common listed Hisun intake valve part number is 14711-007-0000 and ERP part number is 14711-007-0000. Also applies to some other variations of Hisun models.

Common Nordik model names are primarily listed "Storm 700 EFI ATV". Common listed Nordik intake valve part number is 14711-007-0000 and ERP part number is 14711-007-0000. Also applies to some other variations of Nordik models.

Common Powermax model names are primarily listed as "Powermax Bearclaw 700 ATV". Common listed Powermax intake valve part number is 14711-007-0000 and ERP part number is 14711-007-0000. Also applies to some other variations of Powermax models.

- Manufacturer PN: 14711-007-0000